

210100

ECN # or INIT	REV	DESCRIPTION	DATE
OE-005	A1	REDRAWN TO AutoCAD	16-APR-2013
OE-013	A2	REVISED HOOP PROFILE	19-APR-2013

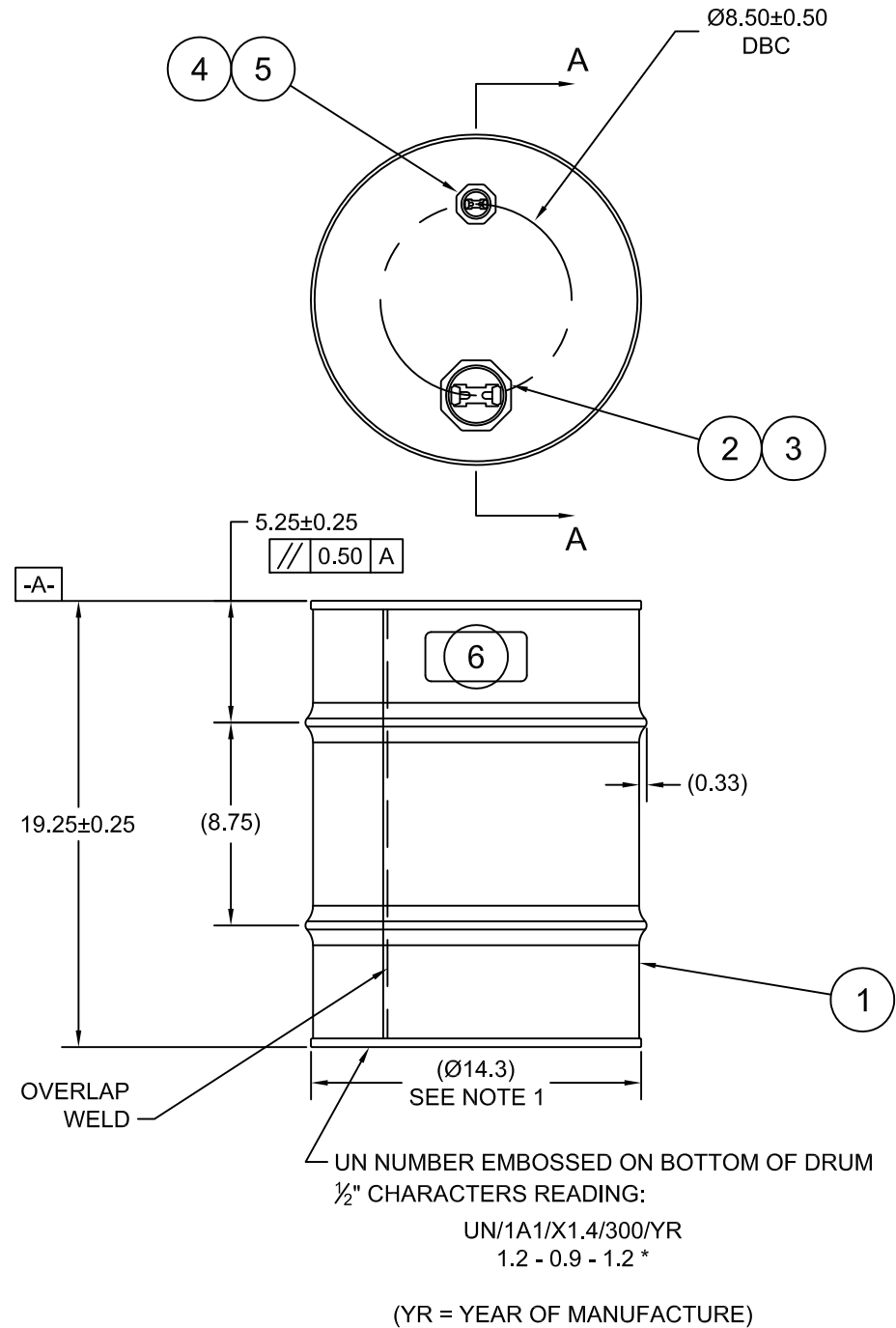

SECTION A-A
SHOWN W/ PLUGS REMOVED

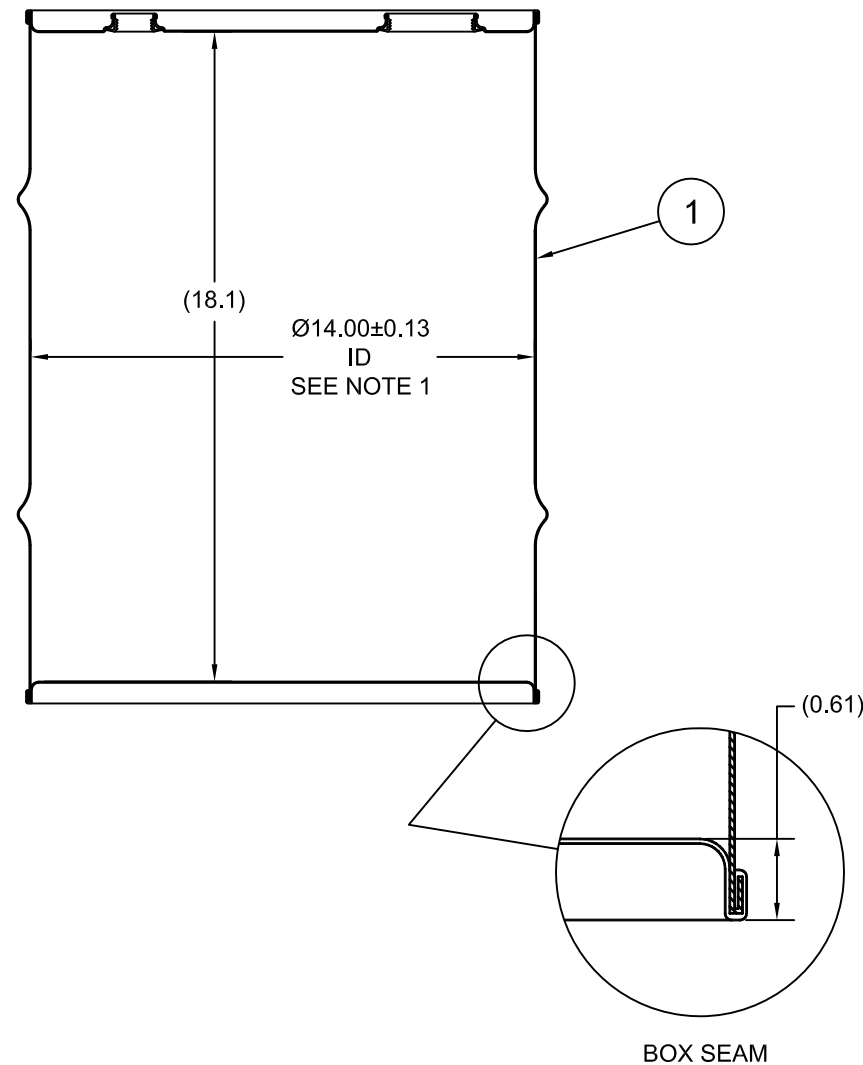

NOTES:

- TO DETERMINE GREATER ACCURACY OF ANY DIAMETRIC DIMENSION, MEASURING OF CIRCUMFERENCE IS REQUIRED
- CONSTRUCTION per 49 CFR §178.504 (b)

MATERIAL:

- DRUM BODY AND COVER CRCQ CARBON STEEL PER ASTM A1008 AND ASTM A568 OR EQUIVALENT
- MATERIAL THICKNESS TOP/BOTTOM 1.2mm (0.0433 - 0.0480, 18 GAUGE), BODY 0.9mm (0.0319 - 0.0370, 20 GAUGE)

FINISH:

- DRUM BODY/BOTTOM EXTERIOR PAINTED BLACK (LQ10003)
TOP PAINTED WHITE (LQ10020)

6		UN DURABLE LABEL	1
5	PT3000	PLUG 3/4 TS BUNA GASKET	1
4	FT3000	FLANGE 3/4 TS BUNA GASKET	1
3	PT2000	PLUG 2 TS BUNA GASKET	1
2	FT2000	FLANGE 2 TS BUNA GASKET	1
1		10 GALLON TIGHT HEAD DRUM	1
ITEM	P/N	DESCRIPTION	QTY

MFG BR	DRW LJT	CHK JG
SLS DR	QA MD	

UNLESS STATED OTHERWISE

(DIMENSIONS IN PARENTHESIS ARE FOR REFERENCE ONLY!!!)

ALL DIMENSIONS ARE IN INCHES
DO NOT SCALE DRAWING

TOLERANCES:
FRACTIONS ±1/4
X° ± 3°
X.X ± 0.2
X.XX ± 0.10
X.XXX ± 0.030

SKOLNIK INDUSTRIES, INC.
4900 SOUTH KILBOURN AVENUE, CHICAGO, IL 60632

DESCRIPTION
10 GALLON TIGHT HEAD DRUM
1.2 - 0.9 - 1.2 CRCQ STEEL
1A1/X1.4/300

REL. DATE	PART NUM. / FILENAME	REV
-	CQ1012	A2

TARE WEIGHT:
15 lbs

THE USE OF INFORMATION CONTAINED HEREIN IS RESTRICTED FOR THE BENEFIT OF SKOLNIK INDUSTRIES ONLY. UNAUTHORIZED USE OR DISCLOSURE, COPYING OR OTHERWISE REPRODUCING (IN ANY MANNER) ANY PORTION OF THIS DRAWING WITHOUT PRIOR WRITTEN PERMISSION OF AN AUTHORIZED OFFICIAL OF SKOLNIK INDUSTRIES IS STRICTLY PROHIBITED.

APR
G. Petersen
FILE CREATED IN
AutoCAD 2002

